



# 5000 Series Bottled Water System

FOR HOME AND COMMERCIAL APPLIANCES

## Genuine Flojet bottled water system is ideal where portability is key

Pump recipe-quality water from commercial bottles to ensure better-tasting hot and cold beverages. The new 5000 Series Bottled Water System is designed to work with coffee/tea makers, refrigerator ice and water dispensers, espresso carts and portable sinks or any use requiring portable potable water.

The 5000 Series Bottled Water System is also designed for convenience. The pump automatically shuts off when the water source is depleted and restarts when water is restored. Its compact size supports easy mounting.

## Features and Benefits

- **Illuminated On/Off Switch:** Provides clear visibility in dark or hard-to-reach places
- **Long-Life Motor:** Ensures years of reliable operation
- **Flojet Diaphragm Pump:** Runs dry without damage, extending pump life
- **Quick Connect Port:** Speeds installation and replacement of suction and discharge tubing
- **Quiet Operation:** Minimizes noise pollution with noise-dampening rubber feet
- **Thermal Overload Protection:** Prevents overheating, protecting the pump and control box from damage



# 5000 Series Bottled Water System

FOR HOME AND COMMERCIAL APPLIANCES

- In coffee shops around the world, genuine Flojet Bottled Water Systems deliver recipe-quality water for more than two million cups of coffee a day
- Proven electric diaphragm pump technology ensures operational excellence, with more than seven million units in service
- Flojet Bottled Water Systems protect the environment by eliminating water filters from refrigerator dispensing systems, keeping more than 300,000 filters a year out of landfills
- Flojet brands build on 40 years of operational excellence and applications expertise, with a broad range of solutions for the food and beverage industry

## Applications

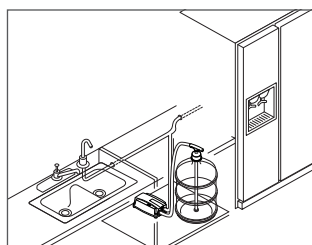

Refrigerator Dispense

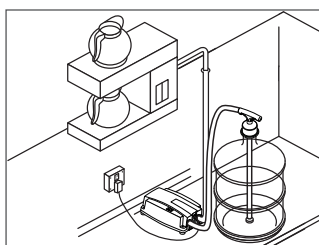

Coffee Maker Dispense

## Dimensional Drawing

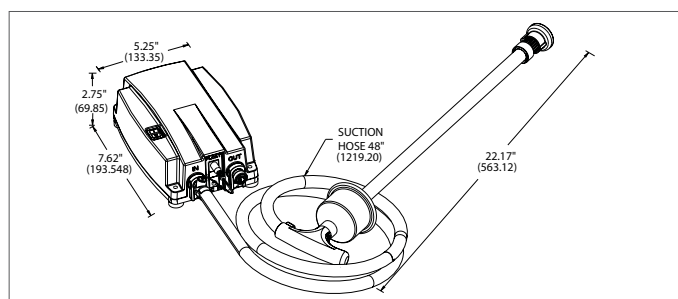

## Specifications

Max Pressure	40 PSI (2.76 bar)
Dimensions	2.95"H x 5.12"W x 7.62"D (74.93 mm H x 130.05 mm W x 193.54 mm D)
Voltages	115 VAC, 230 VAC
Amp Draw	115 VAC, 0.4 amp max 230 VAC, 0.2 amp max
Cycles	50/60 Hz for AC models
Weight	4.5 lbs. (2.04 kg)

Model Number	Voltage	Power adapter type	Certification
BW5000-000A	115 VAC	US Plug	UL NSF
BW5002-000A	230 VAC	AU Plug	CE NSF
BW5003-000A	230 VAC	UK Plug	CE NSF
BW5004-000A	230 VAC	EU Plug	CE NSF

## Includes

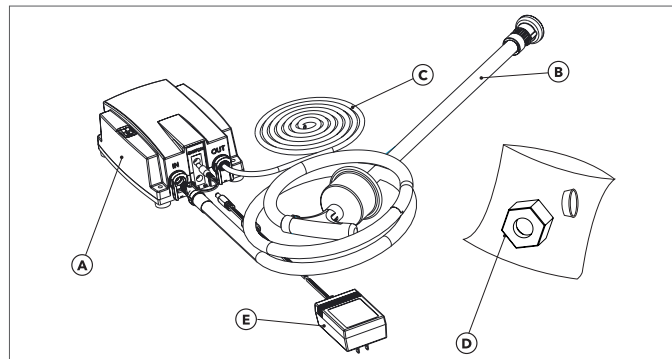

- |  |   |
|--|---|
| A. Main module with On/Off rocker switch           | D. Compression nut and sleeve                         |
| B. Suction Wand and Hose Assembly                  | E. Wall power transformer                             |
| C. Discharge Tube 20 ft (6.1m) 1/4 in. (6.35mm) OD | *Available with US, EU, UK and AU plug configuration. |
|  | *All power adapters have 6 feet (182.9 cm) cable.     |

**xylem**  
Let's Solve Water

Warranty: All products of the company are sold and all services of the company are offered subject to the company's warranty and terms and conditions of sale, copies of which will be furnished upon request. The information provided herein is for guidance only, it does not constitute a guarantee of the performance or specification of any individual product or component.

[www.flojet.com](http://www.flojet.com)

Brewing Gadgets General Trading LLC  
Shop No.1, Building EMR 25  
Emarati Cluster , International City  
Dubai, UAE Phone: +971 4 4474261  
Email: [info@brewinggadgets.com](mailto:info@brewinggadgets.com)  
Website: [www.brewinggadgets.com](http://www.brewinggadgets.com)